

TECHNICAL FEATURES :

- Max speed : 4000rpm
- Max torque : 15Nm
- Ratio : 1:1
- Output : ER20

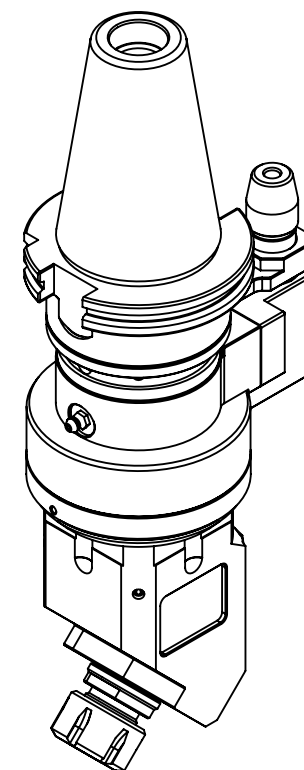

Machine type :

SK50



豪力輝工業股份有限公司
HOLD WELL INDUSTRIAL CO.,LTD

E-mail : sales@mail.holdwell.com
<http://www.holdwell.com>

品號

Model No.

品名

AA A	Description
------	-------------

AHD-SK50-B1.80

D型 SK50-ER20
45度橫向銑頭(中心距80)